

CITY OF SAN MATEO
HOUSING REPORT

Housing Survey No.

A-84

Location 353 No CHARMONT Lot 10 Block 23 Sub Western Addition

Owner Dolfa Lavezzo - same address

Operator _____

Occupants _____ Men _____ Women _____ Children _____

Classification: _____ Hotel _____ Apts. _____ Rooming House _____
Auto Court _____ Dwelling ✓ Miscellaneous Ⓢ

Description 1 STORY - WOOD

Structural Condition	Sewerage	Drainage	Water Supply
Foundation	Floor	Walls	Roof
Bedrooms: Floor	Ceiling	Cu. Air Space	Window Space
Condition	Plaster	Woodwork	Paint
Kitchens: Floor	Ceiling	Window Space	Sink
Plumbing:	Vents	Gas Appl.	Violation
Toilets	Plumbing	Window Space	Ventilation
Baths	Showers	Plumbing	Vents
Basement	Floor	Ceiling	Ventilation
Stairways	Condition	Railing	Lighting
Hallways	Exits	Lighting	Ventilation
Heating Appls:	Condition	Vented	Shutoff Valve
Electric Wiring	Condition	Outlets	Conduits
Fire Hazards:	Furniture	Boxes	Junk
Garbage:	Cans	Disposal	Violations
Rodents	Harbors	Fowl Pens	Animals
Flies	Roaches	Vermin	Other insects
Set-back	Front	Side	Rear
Exposure	Type	Side	Rear

All need
 done
 2-4-58
 [Signature]

REMARKS: SEE OTHER SIDE

2-4-58 - Inspect. - Approval

12-2-57 Inspect. made with Health Dept. (Klein) see note

Rating: A (B) C D Date: 11-13-57 Inspector Savage

Law Applicable: _____ City Ord. # _____

Time Allowed for Corrections: _____ Inspector's Time Used: _____

Inspections Dates: _____

Refer to Dist. Atty. _____ City Atty. _____ Bldg. Insp. _____

BD-1011
9-25-57:j1

(Field Drawing on Reverse Side)

B.P. 32578
 saved 1/2/58
 [Signature]
 EXT. To-2-458

LETTER A DR

OCTAGON WAS FORMERLY
PLOT PLAN

THE OTHER SIDE OF THE ROAD

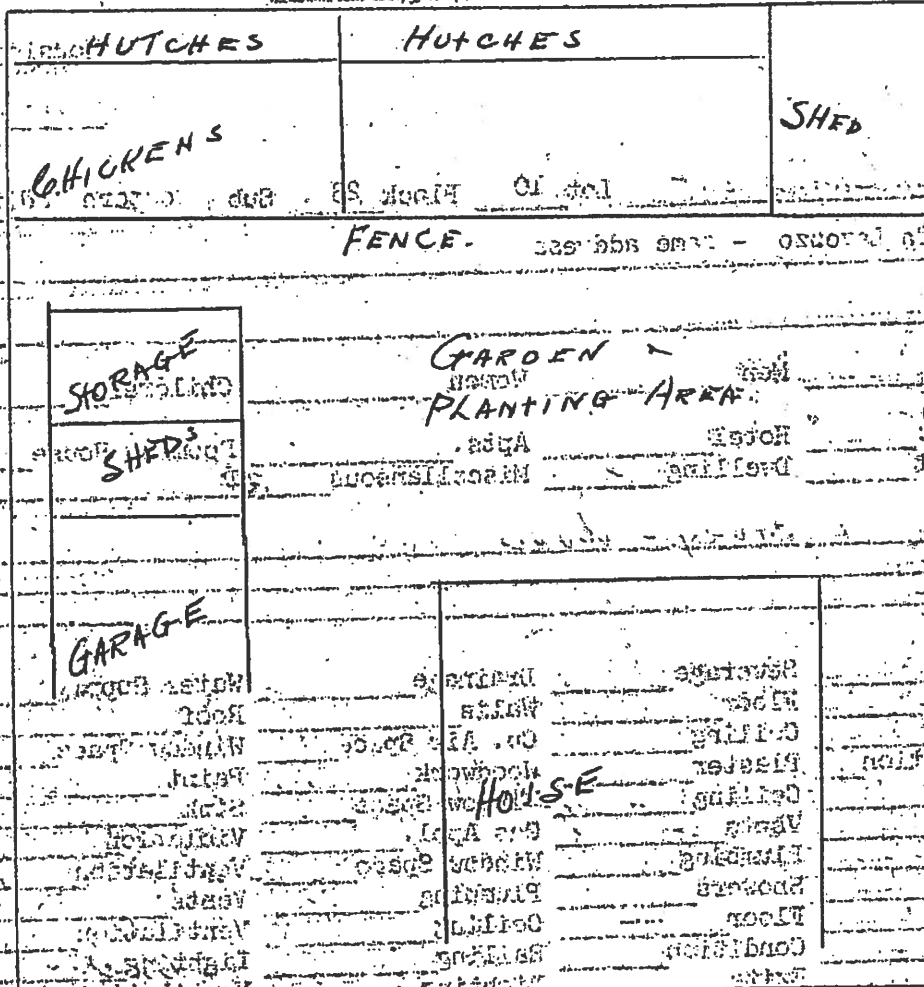

REMARKS:

RABBITS - CHICKENS - ETC
PENS + CHICKEN PENS ARE DIRTY -
CHICKENS FED ON GROUND -

OWNER SAYS GOING TO ABATE ALL
PENS + SHEDS SOON -